

● ONE MILLENNIUM BRIDGE

**A 7,618 SQ FT ROOFTOP RESTAURANT OPPORTUNITY
OVERLOOKING THE RIVER THAMES**



● ONE
MILLENNIUM
BRIDGE

SITTING ADJACENT TO THE MILLENNIUM
BRIDGE ON THE NORTHERN BANK OF THE
RIVER THAMES, THE ROOFTOP RESTAURANT
SITS ABOVE A BUSTLING 250,000 SQ FT
OFFICE BUILDING AT THE HEART
OF LONDON.



An indicative aerial view of One Millennium Bridge

ONE MILLENNIUM BRIDGE

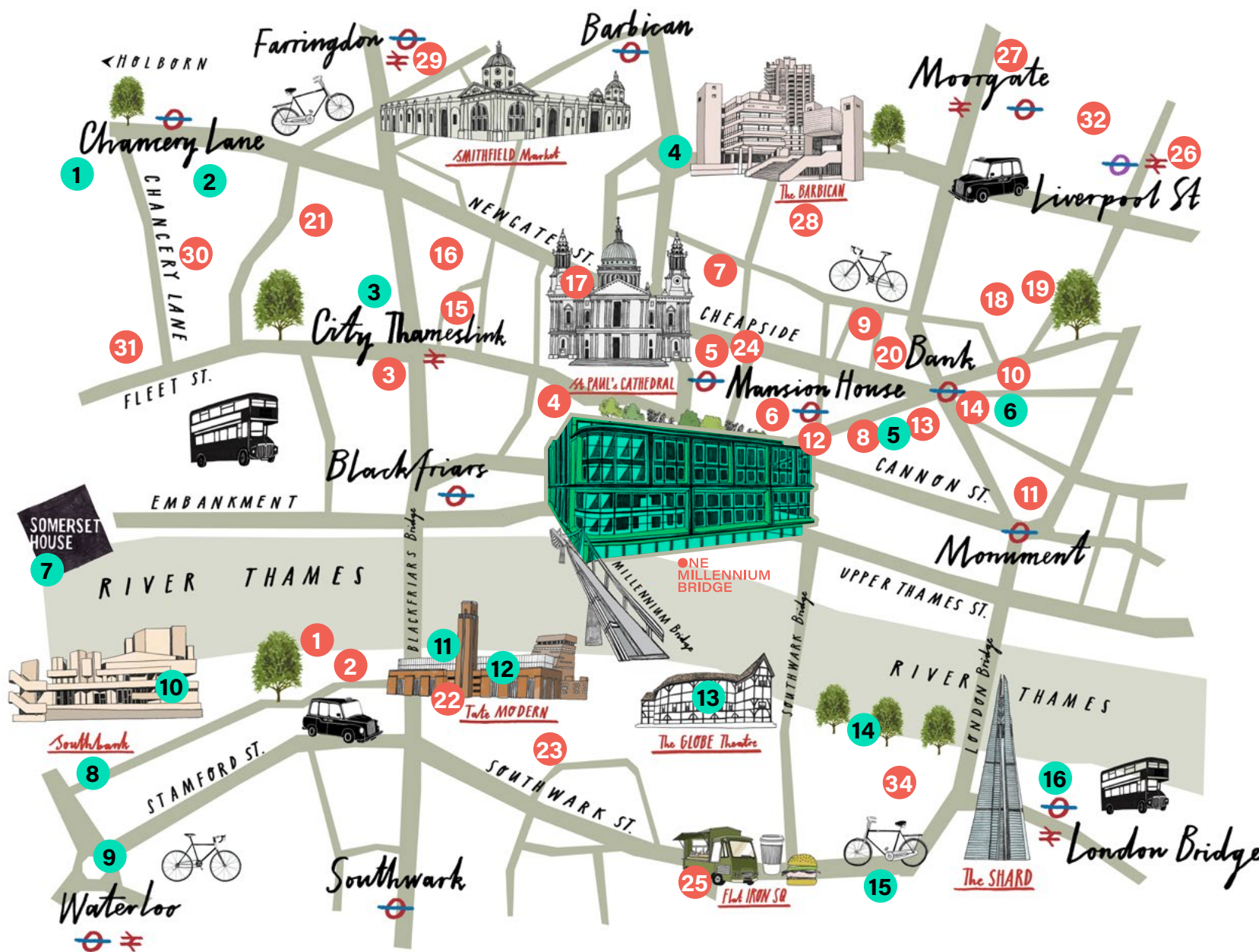

FOOD & DRINK

1. OXO Tower Restaurant
2. 12th Knot
3. City of London Distillery & Bar
4. Mangio Pasta & Bottega
5. The Ivy Asia
6. Enoteca da Luca
7. HAZ
8. Ekte Nordic Kitchen
9. Goodman City
10. Burger & Lobster - Threadneedle St
11. The Folly
12. Mercer Roof Terrace
13. Bloomberg
14. 1 Lombard St
15. Paternoster Chop House
16. Uzumaki
17. The Happenstance
18. COYA Angel Court
19. City Social
20. The Ned
21. Guido's
22. Tate Modern Terrace Bar
23. Capricci
24. F1 at One New Change (Leisure and arts)
25. Caravan Bankside
26. Duck & Waffle
27. Angler
28. Barbie Green
29. Vinoteca
30. Honi Poke
31. Brasserie Blanc - Chancery Lane
33. Eataly
34. Borough Market

LEISURE & ARTS

1. Sir John Soane's Museum
2. Hunterian Museum
3. CIRQ: HIIT & Circuit Training Gym
4. Museum of London
5. Virgin Active
6. Gymbox Bank
7. HQS Wellington
8. British Film Institute Southbank
9. IMAX
10. Skylark Galleries
11. Bankside Gallery
12. Tate Modern
13. The Globe
14. The Clink Prison Museum
15. Kings Sport London Bridge
16. RIBO Galleries

SET AMONGST A PLETHORA OF **PRESTIGIOUS ORGANISATIONS**

Sitting in a spectacular location on Millennium Bridge, this best-in-class rooftop restaurant is nestled in a bustling 7 day destination. Surrounded by cultural landmarks and a densely packed business district, this destination sees a constant and very high-volume of footfall all year round.

WITHIN A **10 MINUTE WALK**



A UNIQUE **OPPORTUNITY**

A prime location for a restaurant in one of London's busiest areas.



St Paul's 7 mins
St Paul's Cathedral
Bank 8 mins
Mansion House 4 mins
Blackfriars 4 mins
Cannon St 5 mins
Bankside (Ferry) 5 mins
Borough Market
Tate Modern 5 mins
The Shard
Shakespeare's Globe 6 mins
Southbank
Waterloo 15 mins



● **ONE
MILLENNIUM
BRIDGE**

All travel times are taken from TFL and are door to door including walking / tube travel

● ONE
MILLENNIUM
BRIDGE

AN UNRIVALLED
OPPORTUNITY WITH
PANORAMIC VIEWS
ACROSS THE THAMES





ONE
MILLENNIUM
BRIDGE

An indicative view of the restaurant terrace







● ONE
MILLENNIUM
BRIDGE

LEVEL 6

APPROXIMATE GROSS INTERNAL AREA
7,618 SQ FT

WEST RESTAURANT TERRACE
2,400 SQ FT

EAST RESTAURANT TERRACE
3,750 SQ FT

TOTAL RESTAURANT AND TERRACE AREA
13,768 SQ FT

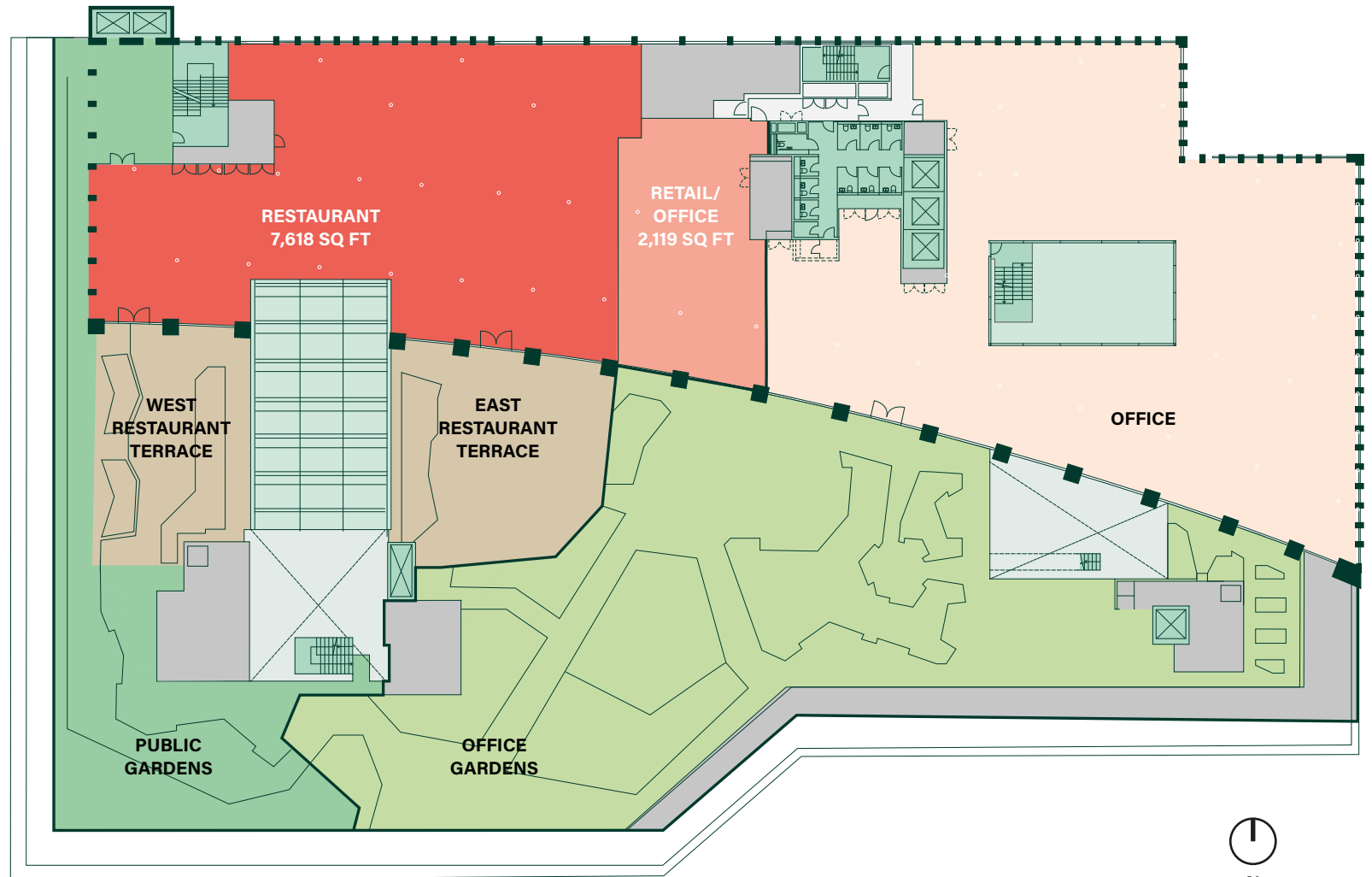

● ONE
MILLENNIUM
BRIDGE



Susie Buss
Susie.buss@jll.com
+44 (0)7807 079 971

David Carlsson
David.carlsson@jll.com
+44 (0)7904 949 275

Lydia Pattihis
Lydia.pattihis@jll.com
+44 (0)7720 070 452



Dominic Tixerant
Dominic@brucegillinghampollard.com
+44 (0)7742 756 817

Rupert Bentley-Smith
Rupert@brucegillinghampollard.com
+44 (0)7876 354 160

A DEVELOPMENT BY



BELTANE

