

# ● ONE MILLENNIUM BRIDGE

**A 7,618 SQ FT ROOFTOP RESTAURANT OPPORTUNITY  
OVERLOOKING THE RIVER THAMES**



● ONE  
MILLENNIUM  
BRIDGE

SITTING ADJACENT TO THE MILLENNIUM  
BRIDGE ON THE NORTHERN BANK OF THE  
RIVER THAMES, THE ROOFTOP RESTAURANT  
SITS ABOVE A BUSTLING 250,000 SQ FT  
OFFICE BUILDING AT THE HEART  
OF LONDON.



An indicative aerial view of One Millennium Bridge

# ONE MILLENNIUM BRIDGE

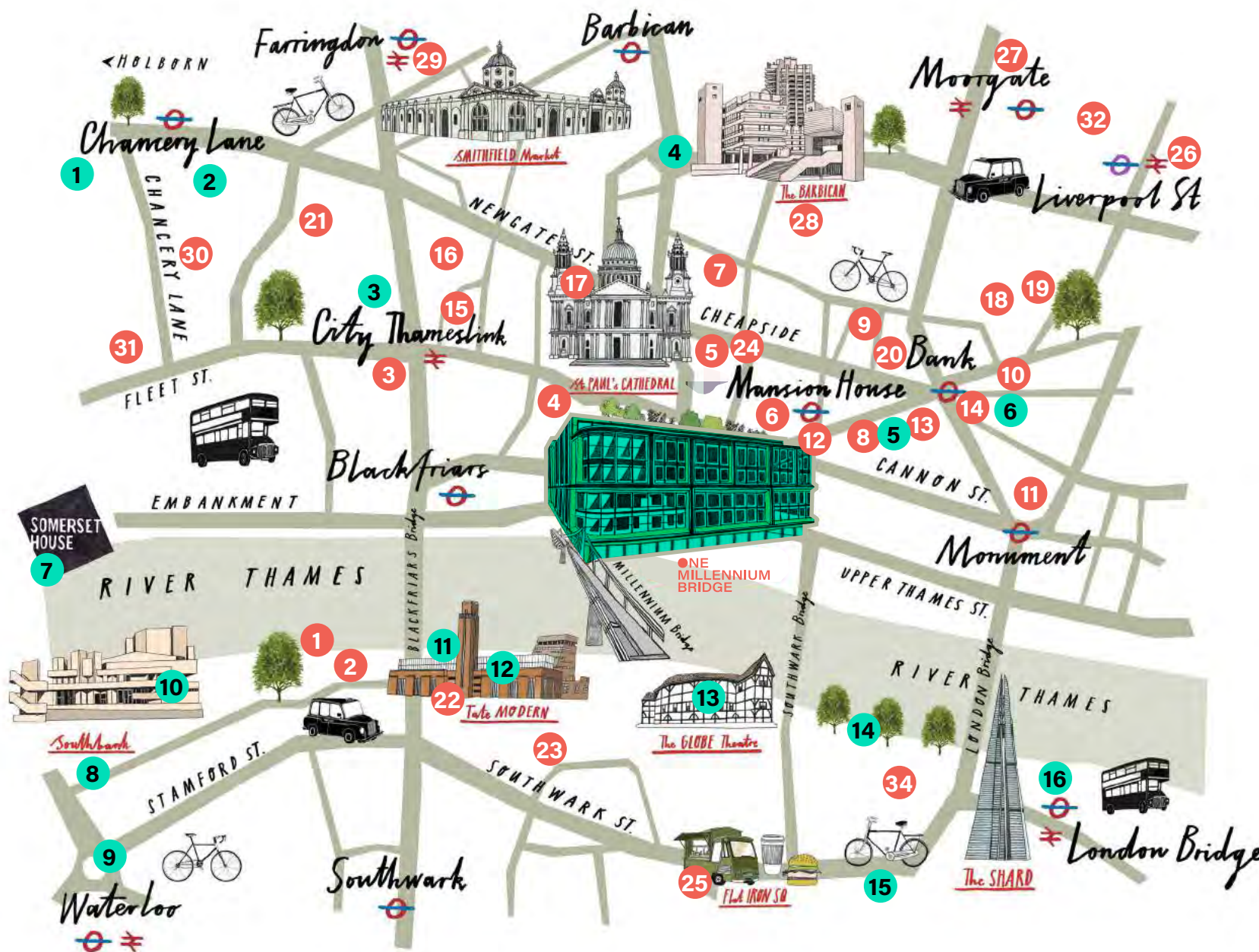

## FOOD & DRINK

1. OXO Tower Restaurant
2. 12th Knot
3. City of London Distillery & Bar
4. Mangio Pasta & Bottega
5. The Ivy Asia
6. Enoteca da Luca
7. HAZ
8. Ekte Nordic Kitchen
9. Goodman City
10. Burger & Lobster - Threadneedle St
11. The Folly
12. Mercer Roof Terrace
13. Bloomberg
14. 1 Lombard St
15. Paternoster Chop House
16. Uzumaki
17. The Happenstance
18. COYA Angel Court
19. City Social
20. The Ned
21. Guido's
22. Tate Modern Terrace Bar
23. Capricci
24. F1 at One New Change (Leisure and arts)
25. Caravan Bankside
26. Duck & Waffle
27. Angler
28. Barbie Green
29. Vinoteca
30. Honi Poke
31. Brasserie Blanc - Chancery Lane
33. Eataly
34. Borough Market

## LEISURE & ARTS

1. Sir John Soane's Museum
2. Hunterian Museum
3. CIRQ: HIIT & Circuit Training Gym
4. Museum of London
5. Virgin Active
6. Gymbox Bank
7. HQS Wellington
8. British Film Institute Southbank
9. IMAX
10. Skylark Galleries
11. Bankside Gallery
12. Tate Modern
13. The Globe
14. The Clink Prison Museum
15. Kings Sport London Bridge
16. RIBO Galleries

# SET AMONGST A PLETHORA OF **PRESTIGIOUS ORGANISATIONS**

Sitting in a spectacular location on Millennium Bridge, this best-in-class rooftop restaurant is nestled in a bustling 7 day destination. Surrounded by cultural landmarks and a densely packed business district, this destination sees a constant and very high-volume of footfall all year round.

## WITHIN A **10 MINUTE WALK**



## A UNIQUE **OPPORTUNITY**

A prime location for a restaurant in one of London's busiest areas.



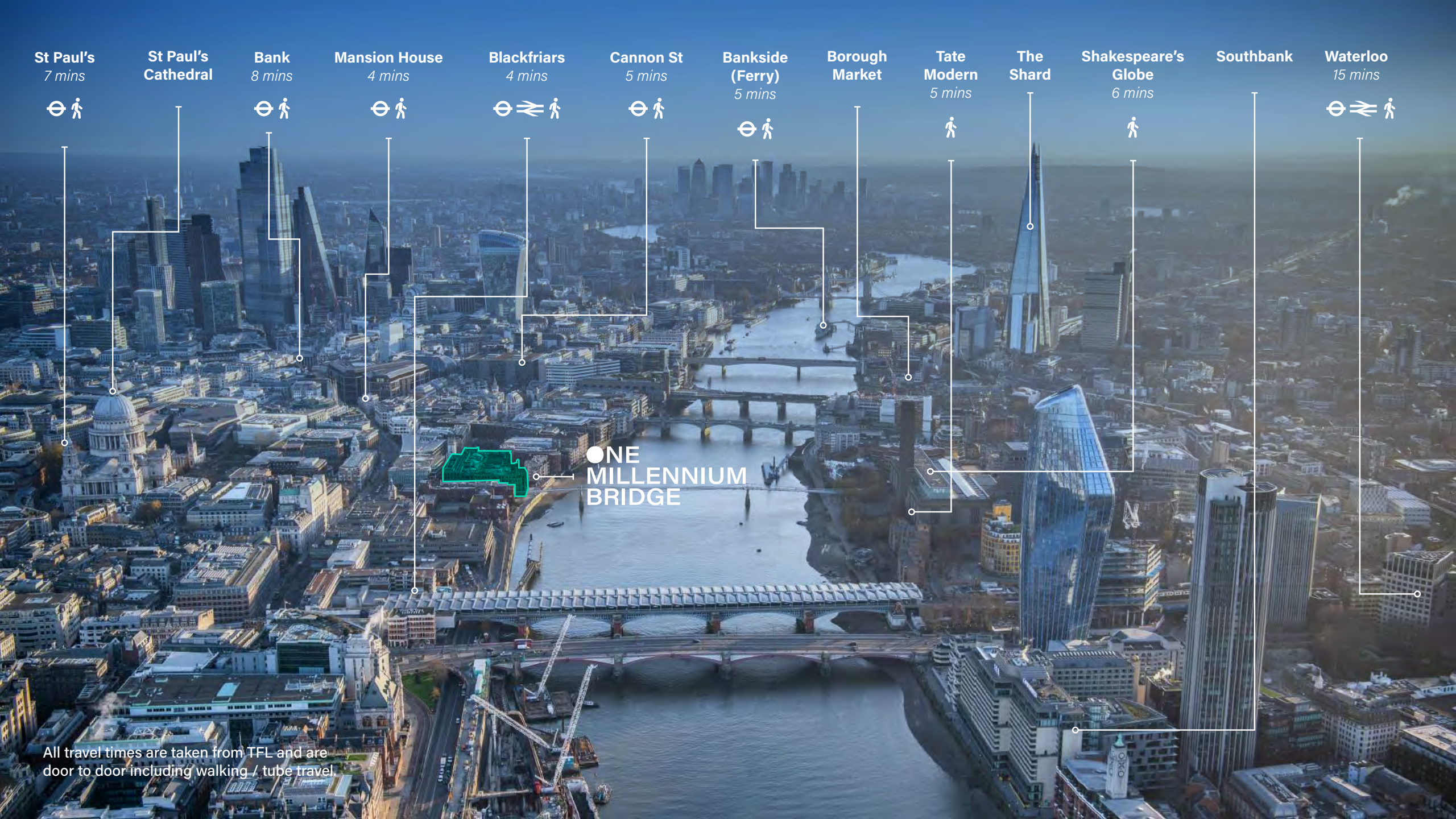

St Paul's  
7 mins



St Paul's  
Cathedral

Bank  
8 mins



Mansion House  
4 mins



Blackfriars  
4 mins



Cannon St  
5 mins



Bankside  
(Ferry)  
5 mins



Borough  
Market

Tate  
Modern  
5 mins



The  
Shard

Shakespeare's  
Globe  
6 mins



Southbank

Waterloo  
15 mins



● ONE  
MILLENNIUM  
BRIDGE

All travel times are taken from TFL and are door to door including walking / tube travel.

● ONE  
MILLENNIUM  
BRIDGE

AN UNRIVALLED  
OPPORTUNITY WITH  
PANORAMIC VIEWS  
ACROSS THE THAMES





ONE  
MILLENNIUM  
BRIDGE

An indicative view of the restaurant terrace









● ONE  
MILLENNIUM  
BRIDGE

LEVEL 6

APPROXIMATE GROSS INTERNAL AREA  
7,618 SQ FT

WEST RESTAURANT TERRACE  
2,400 SQ FT

EAST RESTAURANT TERRACE  
3,750 SQ FT

TOTAL RESTAURANT AND TERRACE AREA  
13,768 SQ FT

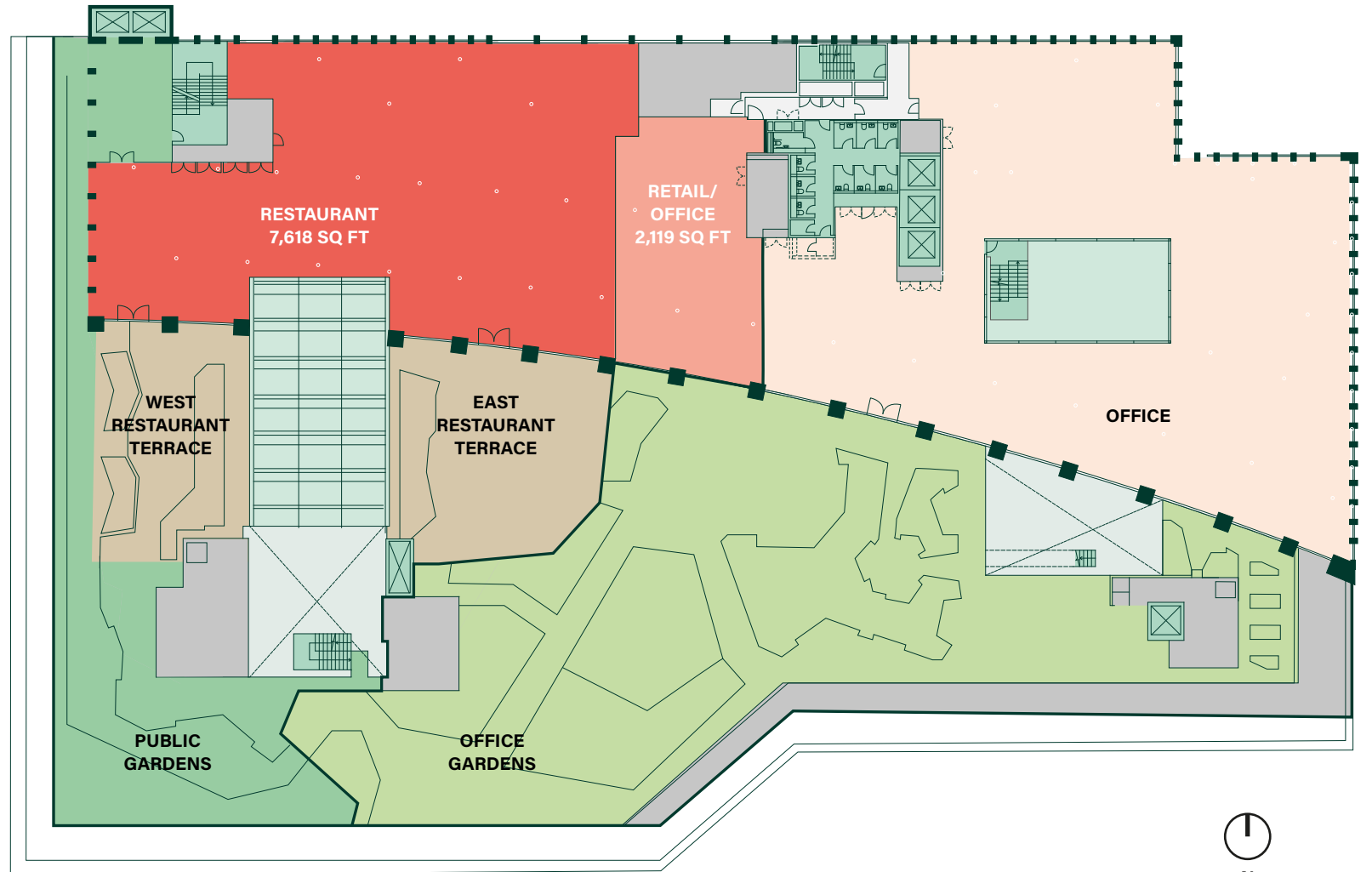

# ONE MILLENNIUM BRIDGE

A DEVELOPMENT BY



**BELTANE**



**ANGELO,  
GORDON  
& CO.**

## CBRE

**David Perowne**  
david.perowne@cbre.com  
+44 (0)7739 814 720

**Tom Meijer**  
tom.meijer@cbre.com  
+44 (0)7540 595 379

**Hannah Grint**  
hannah.grint@cbre.com  
+44 (0)7545 868 543

## RX LONDON

**Frankie Warner Lacey**  
frankie.warnerlacey@rx.london  
+44 (0)7775 895 661

**Dan Burn**  
dan.burn@rx.london  
+44 (0)7515 607 011

**Hannah Buxton**  
hannah.buxton@rx.london  
+44 (0)7976 747 569

## CUSHMAN & WAKEFIELD

**Alistair Brown**  
alistair.brown@cushwake.com  
+44 (0)7771 527 350

**Alex Novelli**  
alex.novelli@cushwake.com  
+44 (0)7860 594 752

This proposal is believed to be correct at the date of publication but its accuracy is in no way guaranteed, neither does it form part of any contract. All areas, measurements and dimensions are approximate. CGI renders shown are for illustrative purposes only. Issued Q2 2024.