

LANDMARK RETAIL
& RIVER FRONTING
**RESTAURANT
OPPORTUNITIES**



LANDMARK RETAIL
& RIVER FRONTING
RESTAURANT
OPPORTUNITIES



OUTSTANDING LANDMARK CITY
RIVER FRONT RESTAURANT
& RETAIL OPPORTUNITIES.
HIGHLY PROMINENT & SITTING
WITHIN A NEW 250,000 SQ FT
OFFICE DEVELOPMENT.



An indicative aerial view of One Millennium Bridge.

NESTLED BETWEEN ICONS



An indicative view of the arrival sequence looking North showing bridge level units 1 and 2 either side of the office entrance.

FOOD & DRINK

1. OXO Tower Restaurant
2. 12th Knot
3. City of London Distillery & Bar
4. Mangio Pasta & Bottega
5. The Ivy Asia
6. Enoteca da Luca
7. HAZ
8. Ekte Nordic Kitchen
9. Goodman City
10. Burger & Lobster
11. The Folly
12. Mercer Roof Terrace
13. Bloomberg
14. 1 Lombard St
15. Paternoster Chop House
16. Uzumaki
17. The Happenstance
18. COYA Angel Court
19. City Social
20. The Ned
21. Guido's
22. Tate Modern Terrace Bar
23. Capricci
24. F1 at One New Change
25. Caravan Bankside
26. Duck & Waffle
27. Angler
28. Barbie Green
29. Vinoteca
30. Honi Poke
31. Brasserie Blanc
32. Eatly
33. Borough Market

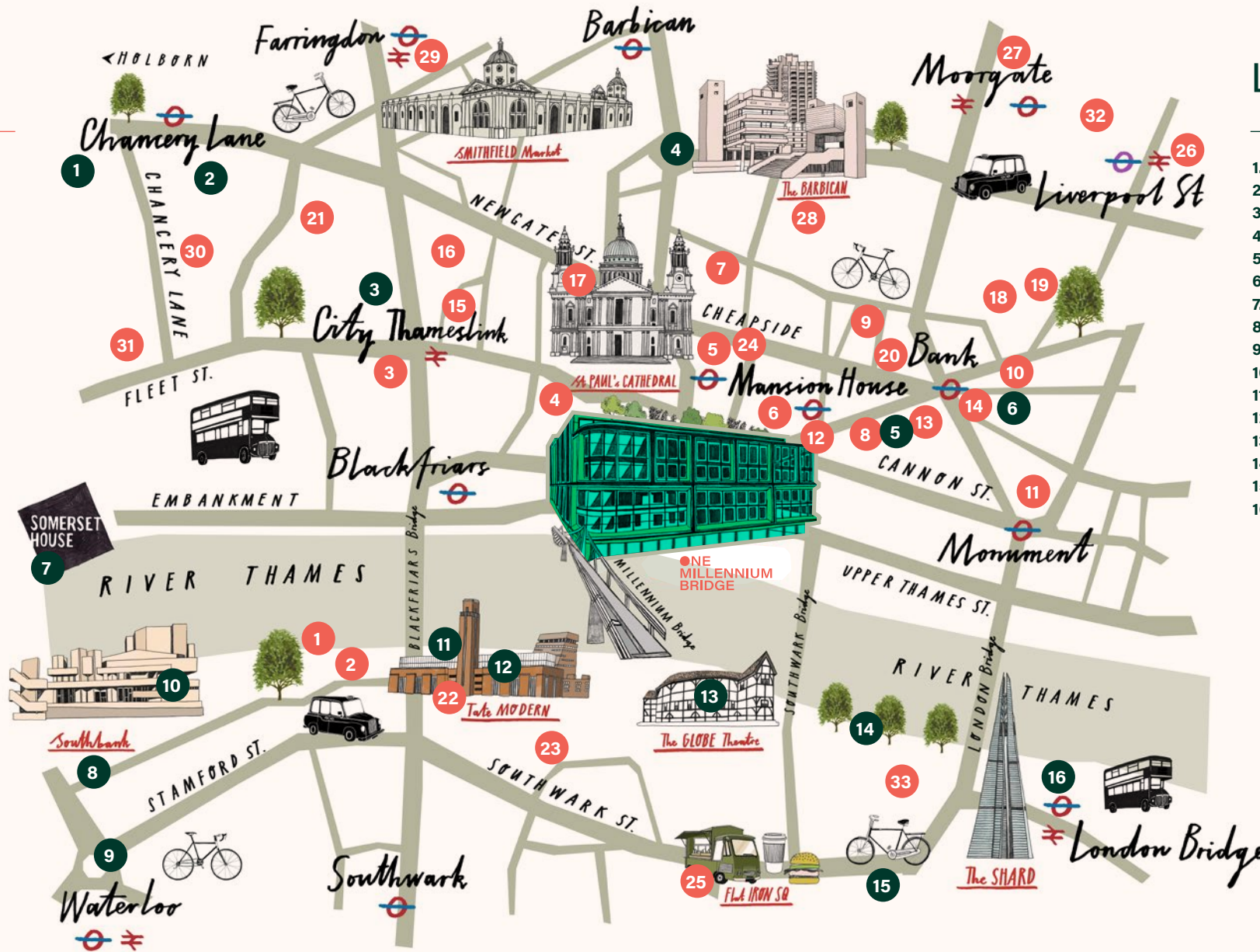

LEISURE & ARTS

1. Sir John Soane's Museum
2. Hunterian Museum
3. CIRQ: HIIT & Circuit Training Gym
4. Museum of London
5. Virgin Active
6. Gymbox Bank
7. HQS Wellington
8. British Film Institute Southbank
9. IMAX
10. Skylark Galleries
11. Bankside Gallery
12. Tate Modern
13. The Globe
14. The Clink Prison Museum
15. Kings Sport London Bridge
16. RIBO Galleries

St Paul's Cathedral



Southbank Centre



Tate Modern

WORLD RENOWNED CULTURAL LANDMARKS

Immerse yourself in London's cultural heartland. Where curators, innovators and makers meet.



Shakespeare Globe



Borough Market



Mizuho Bank Ltd
Two New Ludgate, London, EC4



K&L Gates LLP
One New Change, London, EC4



BNY Mellon
160 Queen Victoria Street, London, EC4



Financial Times
Bracken House, 1 Friday Street, London, EC4

Vintry & Mercer Hotel
1920 Garlick Hill, London, EC4

AMIDST ESTABLISHED NEIGHBOURS

Situated in the heart of London's global financial and professional services centre, with numerous global HQs and hotels close by.

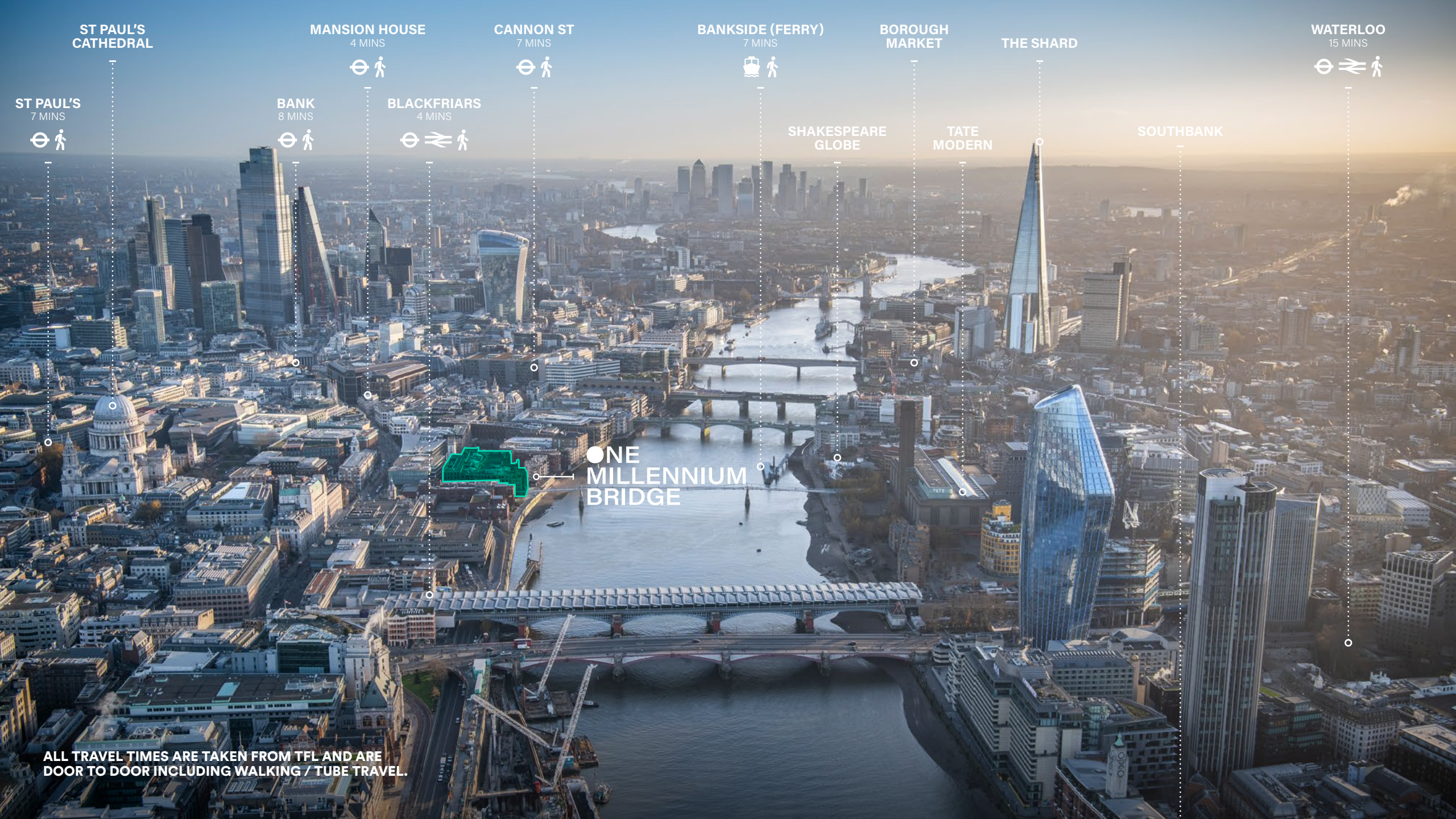

ST PAUL'S CATHEDRAL

MANSION HOUSE
4 MINS

CANNON ST
7 MINS

BANKSIDE (FERRY)
7 MINS

BOROUGH MARKET

THE SHARD

WATERLOO
15 MINS



BANK
8 MINS

BLACKFRIARS
4 MINS

SHAKESPEARE GLOBE

TATE MODERN

SOUTHBANK

ST PAUL'S
7 MINS



● ONE MILLENNIUM BRIDGE

ALL TRAVEL TIMES ARE TAKEN FROM TFL AND ARE DOOR TO DOOR INCLUDING WALKING / TUBE TRAVEL.

RIVER LEVEL

RESTAURANT UNIT 1

U/O

RESTAURANT UNIT 2

5,001 sq ft

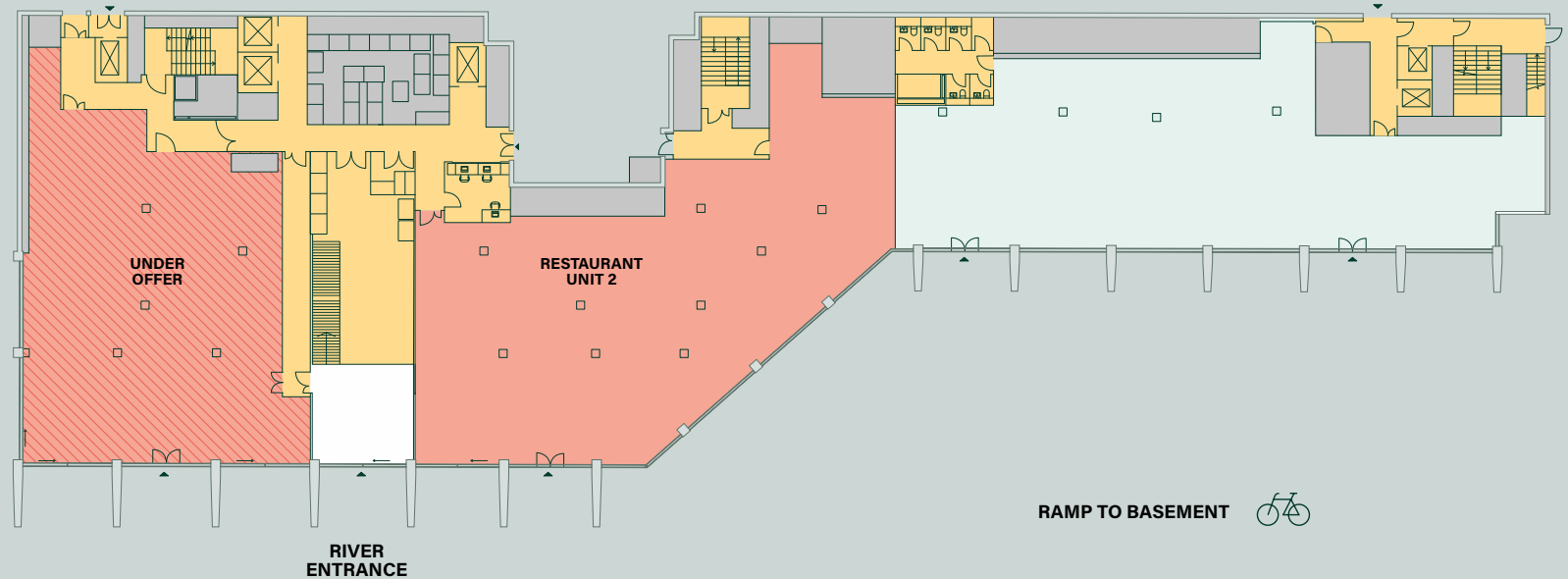

- - Office
- - Core
- - Retail
- - Retail Under Offer
- - Reception
- - Plant





An indicative view out from river level restaurant unit 2, offering spectacular views of the Southbank including the Tate Modern, Shakespeare's Globe Theatre and The Millennium Bridge.



An indicative view of river level restaurant unit 2 at night.



An indicative view of the Level 6 Roof Terrace.

● ONE MILLENNIUM BRIDGE



DAVID CARLSSON
david.carlsson@jll.com
+44 (0)7904 949 275

LYDIA MELAISI
lydia.melaisi@jll.com
+44 (0)7720 070 452

**BRUCE
GILLINGHAM
POLLARD**

DOMINIC TIXERANT
dominic@brucegillinghampollard.com
+44 (0)7742 756 817

RUPERT BENTLEY-SMITH
rupert@brucegillinghampollard.com
+44 (0)7876 354 160

A DEVELOPMENT BY



ANGELO,
GORDON
& CO.



BELTANE

This proposal is believed to be correct at the date of publication but its accuracy is in no way guaranteed, neither does it form part of any contract. All areas, measurements and dimensions are approximate. CGI renders shown are for illustrative purposes only. Issued Q1 2025 .